

JACUZZI®

SHERLOK® *It's Elemental* **Element Filter**

Owner's Manual and Installation Guide

E1530

Congratulations! You have purchased one of the most user-friendly pool filters available. Jacuzzi is a leader in providing superior products, combining easy installation and simple service.

This Sherlock Element filter manufactured by Jacuzzi Bros. will provide you with many years of pool enjoyment. Ideal for most pools, your Sherlock Element filter with Ring-Lok access allows you to easily clean the filter cartridge without any tools.

This step-by-step installation and maintenance guide will provide the necessary information for you to install your new filter and easily maintain the equipment.

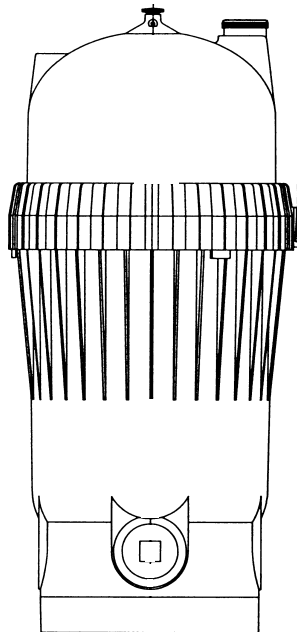

12401 Interstate 30 P.O. Box 8903 Little Rock, AR 72219-8903 Telephone: (501) 455-1234

Before Installation be sure to read all instructions and warnings carefully.

Refer to product dataplate(s) for additional operating instruction and specifications.

INSPECTION

Examine the equipment when received. Notify your dealer or carrier of any damage or missing parts. Verify that equipment is of size and model specified.

INSTALLATION LOCATION

Locate unit on a solid foundation as close to pool/spa as possible. Give consideration to drainage--away from equipment, ventilation, and access for future servicing and winterizing.

PUMP SELECTION

A full line of pool/spa pumps are available for installation with these filters. For those installations where the equipment will be placed above the water level, a self-priming pump should be selected. Ask your dealer to determine the proper size pump for your application. Consideration must be given to pipe size and distance from pool or spa and friction losses of associated equipment.

GENERAL PLUMBING

FOR SOLVENT WELD CONNECTIONS

Rigid or flexible PVC pipe can be used. Pipe ends should be clean and free of any flask caused by the cutting operation. Be sure that the proper adhesive is used on the type of pipe specified.

Recommended Adhesives--These are examples only and are not intended to restrict brands.

PVC-PVC Joint

Uni-Weld Pool-Tite 2000
Suregard Flex 20
IPS Weld-On 705

PVC-ABS Joint

Uni-Weld Pool-Tite 2000
Suregard Well-All No. 5
IPS Weld-On 794

Note: A primer will assure that adhesive joints are superior. Suregard P-3000 has a purple tracer to qualify in areas where codes specify a primer must be used.

Caution: We recommend that you consider climatic conditions when applying adhesives. Certain atmospheric situations, such as high moisture content, make the adhesive action of certain glues less effective. Check the manufacturer's instructions.

FOR THREADED CONNECTIONS

Use only Teflon tape or equivalent on threaded plumbing connections. Other pipe compounds may damage threads.

We do not recommend the use of silicone or petroleum based compounds. **DO NOT OVERTIGHTEN-HAND TIGHTEN PLUS 1/2 TURN IS SUFFICIENT.**

FILTER PLUMBING

Your filter is provided with 1-1/2" NPT or 2" NPT threaded inlet and outlet. When installing, look for the words PUMP and RETURN molded into the filter body.

When the filter is located below water level, a valve should be installed at both PUMP and RETURN. Shutting off both of these valves will prevent loss of water during regular maintenance.

FILTER START UP

1. Check to be sure assembly nut on filter is tight and lock tabs engaged and drain valve closed. Open air relief.
2. Perform start up.
3. Close vent when droplets first appear. An excessive spray of water may occur if venting is not done slowly.

WINTERIZING

Consult your dealer for advice on winterizing your equipment if freezing temperatures occur in your locality. His knowledge of your equipment makes him the best qualified source of information. Follow his recommendations, and if these include draining the filter, proceed as follows:

1. Clean the filter element and store in dry area.
2. Drain system by removing drain plug.

WATER CHEMISTRY

A proper and consistent use of chemicals is necessary to maintain clean, sanitary water, prevent a spread of germ infection and control the growth of algae which can spoil the appearance and enjoyment of your pool or spa.

Chlorine is the most commonly used chemical to provide clean, sanitary water. Either dry or liquid chlorine (calcium or sodium hypochlorite) can be used which should be added daily as it is dissipated by dirt and germs as well as by the sun and the wind.

It is also important that the correct level of acidity or alkalinity of the pool water be maintained. This is the pH of your pool with pH 7.0 being neutral. Readings above pH 7.0 are alkaline and readings below are acid. A desirable range is 7.2 to 7.4.

FILTER MAINTENANCE

Filter tank and contents should not require attention other than cleaning filter element provided water is kept in continuous chemical balance without heavy dosages of corrosive chemicals.

Note: The element support assembly on the Sherlock automatically purges any accumulated air to maintain the internal water level up to the top of the cartridge. We, however, recommend periodic manual opening of the vent plug to purge any small amounts of air accumulated under the cover.

REMOVING AND CLEANING FILTER ELEMENT

When the new filter is first placed into service, note the reading on the pressure gauge. As dirt builds up in the filter, the pressure reading will increase. When it reads 10 psi above the original reading, the filter element should be cleaned as described below or replaced.

Filter Element Cleaning

1. **STOP** pump.
2. Close inlet and outlet valves if installed (for units below water level).
3. Loosen the yellow air vent on the top of the filter.
4. Remove the Ring-Lok. Push in the top of the yellow locking tab as you begin to rotate the Ring-Lok to allow removal.
5. Using the Lid Removal System tabs on the bottom side of the nut, remove the cover by inserting the tabs between the cover and the body and rotating the nut allowing the tabs to pry the cover upward.
6. Grasp the filter element by its upper edges and remove it from the support pipe.
7. The element can usually be cleaned with a high pressure nozzle on a garden hose. Place the nozzle inside the cartridge and spray outward pushing any trapped debris from the cartridge.

TIP: For optimum cleaning, allow your cartridge to dry. Brush off the remaining dirt and chemicals that will not wash off with the hose. As additional cartridge will allow you uninterrupted enjoyment of your pool during this cleaning procedure.

INSTALLING FILTER ELEMENT

1. Remove and clean the o-ring on the filter body and lubricate with petroleum jelly. Also, clean the o-ring groove on the filter body and the sealing surface inside the filter cover to ensure a leak-free seal. Install the o-ring on the filter body.
2. Clean the dirt catcher at the bottom of the support tube. This assembly can be removed if desired by lifting upward on the support tube while rocking it from side to side. Once clean, replace it by firmly pushing it back into the filter body.
3. Slide the clean filter cartridge back onto the support tube and press it firmly into place.
4. Place the cover on the filter body and press firmly downward until it seats.

TIP: It is easier to replace the cover if the air bleed valve is open.

5. Clean the threads of the Ring-Lok nut and the threads on the filter body with water or a clean rag. Place the Ring-Lok nut on the filter and tighten to the built-in stops on the threads. Be sure the yellow locking tab is fully engaged.

SERVICE & REPAIR PARTS

Refer all service to your local dealer as his knowledge of your equipment makes him the best qualified source of information. Order all repair parts through your dealer. Give the following information when ordering repair parts:

- ✓Unit nameplate information and description of part.
- ✓If the recommendations in the "Questions?" portion of this manual do not solve your particular problem, please contact your local dealer for service.

FILTER TANK LEAKS WATER

- ✓ Split in tank due to freeze or other damage, replace.
- ✓ Lid o-ring damaged, twisted, or not lubricated. Inspect.
- ✓ Lock ring to lid not tight. Inspect and tighten down o engage lock tabs.
- ✓ Air bleed valve loose or O-ring missing. Inspect.
- ✓ Inlet/outlet fittings loose or not sealed. Inspect.

DEBRIS BACK TO POOL

- ✓ Dirty filter. Clean element in filter cleaner or replace.
- ✓ Cracked dirt catcher. Inspect and replace if necessary.
- ✓ O-ring on bottom of dirt catcher damaged. Install, replace with #47-0258-53R.
- ✓ Filter collapsing. By-pass through top of dirt catcher. Inspect or replace.
- ✓ Filter isn't sealed in dirt catcher. Inspect.
- ✓ Filter isn't sealed in dirt catcher. Inspect.
- ✓ Filter is installed upside down. Install top-side. Inspect.

FILTER DOESN'T DEEP WATER CLEAN.

- ✓ Filter collapsing. Bypass through top of dirt catcher. Inspect or replace.
- ✓ Holes in filter. Inspect or replace.
- ✓ Filter installed upside down. Inspect or install top side up.
- ✓ Filter isn't seated in dirt catcher. Inspect or install top side up.
- ✓ Filter isn't seated in dirt catcher. Inspect.
- ✓ Water started out dirty. Continue to filter and clean as necessary.
- ✓ Heavy swimmer load. Clean filter as necessary. 10 PSI rule.
- ✓ Flow rate too low. Increase flow to turn water more often.

PRESSURE DOESN'T DROP IN FILTER AFTER CLEANING

- ✓ Dirty filter. Clean element in filter cleaner or replace.
- ✓ Gate valve closed in return line. Inspect.
- ✓ Return line partially clogged. Inspect.
- ✓ Return fitting clogged. Inspect.

TANK WILL NOT ALIGN WITH BASE MOUNTING HOSES

- ✓ Check position of tank. Rotate.
- ✓ Loosen pump from base to allow filter to move and align.

FILTER LID LEAKING

- ✓ Inspect O-ring, cracks, twisted. Replace.
- ✓ Lid cracked. Replace.
- ✓ Tank cracked. Replace.

PARTS FOR MODELS SHER80 AND SHER120

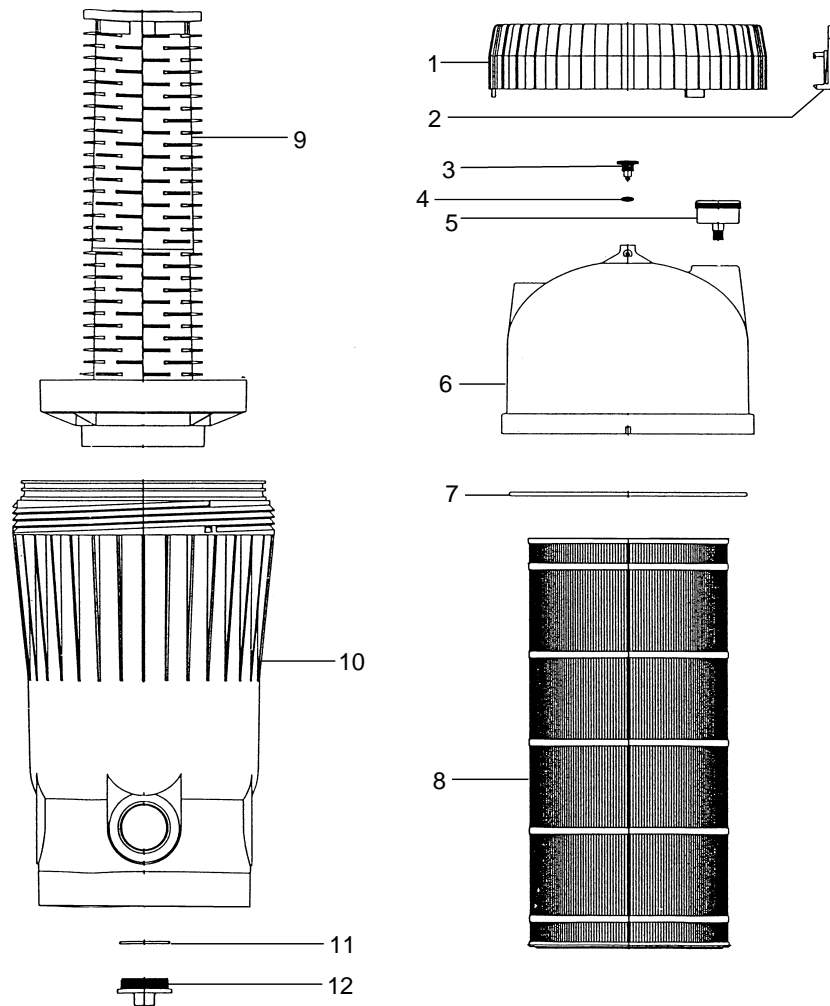

FIGURE NO.	PART NO.	DESCRIPTION
1	42-3671-02-R	Nut CFR-Plus Filter
2	42-3677-06-R	Cover Latch CFR Plus
3	39-2547-01-R	Air bleed valve knob w/ 47-0106-08 O-Ring
4	47-0106-08-R	O-Ring 3/16 x 3/8 x 3/32
5	91-9341-82-R	Pressure Gauge 0-60# 1/4 CBM
6	42-2852-05-R	Cover LS/CFR - 80 Ft.
	42-2998-00-R	Cover LS/CFR - 120 FT.
7	47-0380-47-R	O-Ring 11-1/2 x 11-7/8 x 3/16
8	42-3674-09-R	Element Assy. 80 Ft.
	42-3675-08-R	Element Assy. 120 Ft.
9	42-2946-03-R	Dirt Catcher 80 Ft.
	42-2947-02-R	Dirt Catcher 120 Ft.
10	42-3673-00-R	CFR Plus 2-1/2 body
11	13-0011-02-R	Plug Gasket
12	43-3092-02-R	Plug 2" w/ Gasket 13-0011-02

Manufacturer's Warranty:

LIMITED WARRANTY

Jacuzzi Bros. Division (JBD) warrants its new products to be free of defects in material and workmanship for a period of 1 year from date of installation or 3 years from date of manufacture, whichever comes first. Jacuzzi Bros. also provides additional warranty coverage on specific products as specified herein.

Magnum Plus pumps (excluding pump seal, o-rings, square ring, strainer basket, and lid) are warranted to be free of defects in material and workmanship for a period of 3 years from date of installation or 4 years from date of manufacture, whichever comes first.

Landslide, CFR, and SherLok filter tanks, lids, and Ring-Loks are warranted to be free of defects in material and workmanship for a period of 5 years from date of installation or 6 years from date of manufacture, whichever comes first. This warranty excludes damage or failure caused by freezing.

Laser filter tanks are warranted to be free of defects in material and workmanship for a period of 5 years from date of installation or 6 years from date of manufacture, whichever comes first. This warranty excludes damage or failure caused by freezing. Internal filter components and valves are warranted to be free of defects in material and workmanship for 1 year from date of installation.

All **SandTrap** and **EarthWorks** filter tanks and their Ring-Loks carry an unconditional warranty to be free of defects in material and workmanship for a period of 5 years from date of installation or 6 years from date of manufacture, whichever comes first. Internal filter components and valves are warranted to be free of defects in material and workmanship for 1 year from date of installation.

JBD's warranty obligation with regard to equipment not of its own manufacture is limited to the warranty actually extended to JBD by its suppliers. Performance of equipment is further warranted to be in accordance with stated ratings when properly installed under normal conditions of operation.

This warranty extends only to the original retail purchaser and only during the time in which the original retail purchaser occupies the site where the product was originally installed.

Requests for service under this warranty shall be made by contacting the installing JBD dealer (point of purchase) as soon as possible after the discovery of any alleged defect. JBD will subsequently take corrective action as promptly as reasonably possible.

JBD at its discretion may replace or repair any product that fails under this warranty after inspection by an authorized company representative or after JBD has received the product at our factory. Replacement or repair cannot be made until after the product is inspected. All charges or expenses for freight to and from the factory, removal and reinstallation of the product, or installation of a replacement product are the responsibility of the purchaser.

THIS WARRANTY SUPERSEDES ANY WARRANTY NOT DATED OR BEARING AN EARLIER DATE. ANY IMPLIED WARRANTIES WHICH THE PURCHASER MAY HAVE, INCLUDING MERCHANTABILITY AND FITNESS FOR A PARTICULAR PURPOSE, SHALL NOT EXTEND BEYOND THE APPLICABLE WARRANTY PERIOD. Some states do not allow limitations on how long an implied warranty lasts, so the above limitations may not apply to you. IN NO EVENT SHALL JBD BE LIABLE FOR INCIDENTAL OR CONSEQUENTIAL DAMAGES. Some states do not allow the exclusion of limitation of incidental or consequential damages, so the above may not apply to you.

This warranty does not apply to any product which has been subjected to negligence, alteration, accident, abuse, misuse, improper installation, vandalism, civil disturbances, or acts of God. The only warranties authorized by JBD are those set forth herein. JBD does not authorize other persons to extend any warranties with respect to its products, nor will JBD assume liability for any unauthorized warranties made in connection with the sale of its products.

THIS WARRANTY GIVES YOU SPECIFIC LEGAL RIGHTS, AND YOU MAY ALSO HAVE OTHER RIGHTS WHICH MAY VARY FROM STATE TO STATE.