

Bestway®



OWNER'S MANUAL

www.bestwaycorp.com

Visit Bestway YouTube channel 





WARNING

smooth out the bottom

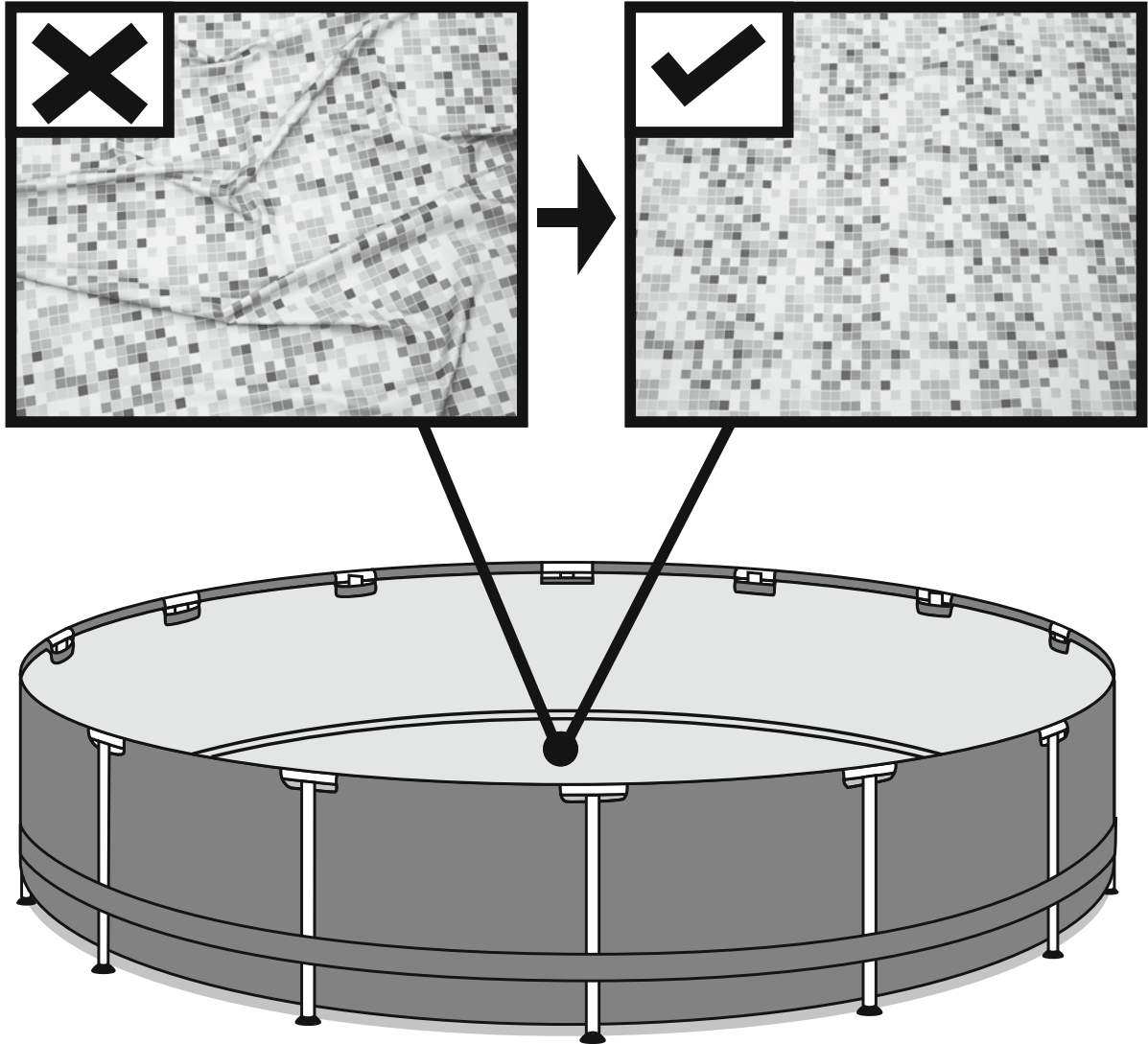

Put 1" to 2" water in the pool to cover the floor. Once pool floor is slightly covered, gently smooth out all wrinkles. Start in the center of the pool and work your way clockwise to the outside.

WARNING

Carefully read, understand, and follow all information in this user manual before installing and using the swimming pool. These warnings, instructions, and safety guidelines address some common risks of water recreation, but they cannot cover all risks and dangers in all cases. Always use caution, common sense, and good judgment when enjoying any water activity. Retain this information for future use.

Non Swimmers safety

- Continuous, active, and vigilant supervision of weak swimmers and non-swimmers by a competent adult is required at all times (remembering that children under five are at the highest risk of drowning).
- Designate a competent adult to supervise the pool each time it is being used.
- Weak swimmers or non-swimmers should wear personal protection equipment when using the pool.
- When the pool is not in use, or unsupervised, remove all toys from the swimming pool and its surrounding to avoid attracting children to the pool.

Safety devices

- In order to prevent children from drowning, it is recommended to secure the access to the pool with a protection device. In order to prevent children climbing from the inlet and outlet valve, it is recommended to install a barrier (and secure all doors and windows, where applicable) to prevent unauthorized access to the swimming pool.
- Barriers, pool covers, pool alarms, or similar safety devices are helpful aids, but they are not substitutes for continuous and competent adult supervision.

Safety equipment

- It is recommended to keep rescue equipment (e.g. a ring buoy) by the pool.
- Keep a working phone and a list of emergency phone numbers near the pool.

Safe use of the pool

- Encourage all users especially children to learn how to swim.
- Learn Basic Life Support (Cardiopulmonary Resuscitation - CPR) and refresh this knowledge regularly. This can make a life-saving difference in the event of an emergency.
- Instruct all pool users, including children, what to do in case of an emergency.
- Never dive into any shallow body of water. This can lead to serious injury or death.
- Do not use the swimming pool when using alcohol or medication that may impair your ability to safely use the pool.

- When pool covers are used, remove them completely from the water surface before entering the pool.
- Protect pool occupants from water related illnesses by keeping the pool water treated and practicing good hygiene. Consult the water treatment guidelines in the user's manual.
- Store chemicals (e.g. water treatment, cleaning or disinfection products) out of the reach of children.
- Use the signage as outlined below. Signage is to be displayed in a prominent position within 2m of the pool.



- Keep children under supervision in the aquatic environment. No diving.
- Removable ladders shall be placed on a horizontal surface.
- Irrespective of materials used for swimming pool construction, accessible surfaces have to be checked regularly to avoid injuries.
- Regularly monitor bolts and screws. Remove splinters or any sharp edges to avoid injuries.
- **ATTENTION!** Do not leave the drained pool outside. The empty pool is liable to become deformed and/or displaced due to wind.
- If you have a filter pump, refer to the pump's manual for instructions.
- **WARNING!** The pump cannot be used while people are inside the pool!
- If you have a ladder, refer to the ladder's manual for instructions.
- **WARNING!** The use of a swimming pool implies compliance with the safety instructions described in the operating and maintenance guide. In order to prevent drowning or other serious injuries, pay particular attention to the possibility of unexpected access to the swimming pool by children under 5 years by securing the access to it, and, during the bathing period, keep them under constant adult supervision.

Please read carefully and keep for future reference

Installation usually takes approximately 20-30 minutes with 2-3 people excluding earthworks and filling.

Part descriptions.

NOTE: Some parts already have been installed on the pool.

POWER STEEL™ POOL & STEEL PRO MAX™ POOL

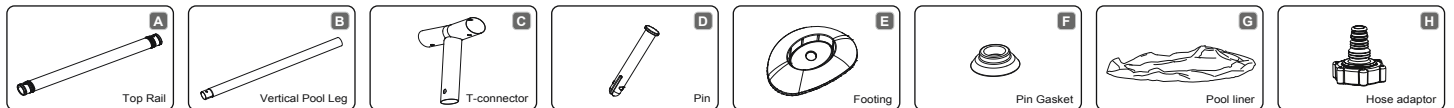

STEEL PRO™ POOL

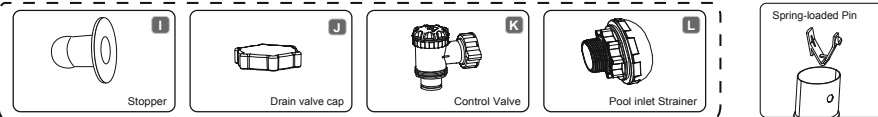
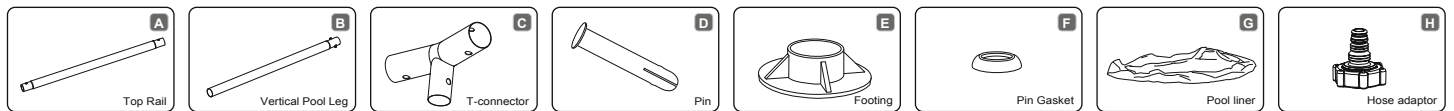

STEEL PRO™ POOL

NO.	#56678 3.05m x 76cm (10'x30")	#14866 3.66m x 76cm (12'x30")
A	10	12
B	10	12
C	10	12
D	22	26
E	10	12
F	22	26
G	1	1
H	1	1
I	3	3
J	1	1
K	0	0
L	0	0

STEEL PRO MAX™ POOL

NO.	#56493 3.05m x 76cm (10'x30")	#56407 3.05m x 76cm (10'x30")	#56417 3.66m x 76cm (12'x30")	#56419 3.66m x 1.00m (12'x39.5")	#56421 3.66m x 1.22m (12'x48")	#56597 4.27m x 84cm (14'x33")	#56686 4.57m x 1.07m (15'x42")	#56439 4.57m x 1.22m (15'x48")	#56463 5.49m x 1.22m (18'x48")
A	10	10	12	12	12	14	15	15	18
B	10	10	12	12	12	14	15	15	18
C	10	10	12	12	12	14	15	15	18
D	22	22	26	26	26	30	32	32	38
E	10	10	12	12	12	14	15	15	18
F	22	22	26	26	26	30	32	32	38
G	1	1	1	1	1	1	1	1	1
H	1	1	1	1	1	1	1	1	1
I	3	3	3	3	3	3	3	3	2
J	1	1	1	1	1	1	1	1	1
K	0	0	0	0	0	0	0	0	1
L	0	0	0	0	0	0	0	0	1

A	P61013	P61013
B	P61014	P61014
C	P61689	P61001
D	P61012	P61012
E	P61010	P61010
F	P61028	P61028
G	56676ASS18	14866ASS18
H	P6D1419	P6D1419
I	P6D1418	P6D1418
J	P6D1158	P6D1158
K	/	/
L	/	/

A	P61780	P61780	P61780	P61780	P61780	P61793	P61793	P61793	P61798
B	P61781	P61781	P61781	P61781	P61789	P61791	P61792	P61794	P61799
C	P61782	P61782	P61786	P61786	P61788	P61790	P61790	P61795	P61800
D	P61783	P61783	P61783	P61783	P61783	P61796	P61796	P61796	P61801
E	P61785	P61785	P61785	P61785	P61785	P61797	P61797	P61797	P61802
F	P61784	P61784	P61784	P61784	P61784	P61784	P61784	P61784	P61784
G	56493ASS18	56493ASS18	56417ASS18	56419ASS18	56421ASS18	56597ASS18	56686ASS18	56439ASS18	56463ASS18
H	P6D1419	P6D1419	P6D1419	P6D1419	P6D1419	P6D1419	P6D1419	P6D1419	P6D1419
I	P6D1418	P6D1418	P6D1418	P6D1418	P6D1418	P6D1418	P6D1418	P6D1418	P6D1418
J	P6D1158	P6D1158	P6D1158	P6D1158	P6D1158	P6D1158	P6D1158	P6D1158	P6D1158
K	/	/	/	/	/	/	/	/	P6(H2)510
L	/	/	/	/	/	/	/	/	P6(H2)1317

POWER STEEL™ POOL

NO.	#56665 4.27m x 1.07m (14'x42")	#56667 4.88m x 1.22m (16'x48")	#56643 4.27m x 1.07m (14'x42")	#56643 4.27m x 1.22m (14'x48")	#56453 4.88m x 1.22m (16'x48")	#56459 5.49m x 1.32m (18'x52")	#56674 6.10m x 1.22m (20'x48")	#56704 6.71m x 1.32m (22'x52")
A	14	16	14	14	16	18	20	22
B	14	16	14	14	16	18	20	22
C	14	16	14	14	16	18	20	22
D	30	34	30	30	34	38	42	46
E	14	16	14	14	16	18	20	22
F	30	34	30	30	34	38	42	46
G	1	1	1	1	1	1	1	1
H	1	1	1	1	1	1	1	1
I	3	2	3	3	2	2	2	2
J	1	1	1	1	1	1	1	1
K	0	1	0	0	1	1	1	1
L	0	1	0	0	1	1	1	1

A	P61769	P61775	P61676	P61676	P61681	P61684	P61684	P61684
B	P61770	P61776	P61336	P61343	P61346	P61352	P61352	P61352
C	P61771	P61777	P61753	P61757	P61758	P61761	P61762	P61763
D	P61772	P61778	P61754	P61754	P61759	P61759	P61759	P61759
E	P61773	P61779	P61756	P61756	P61760	P61760	P61760	P61760
F	P61774	P61774	P61755	P61755	P61755	P61755	P61755	P61755
G	56665ASS18	56667ASS18	56643ASS18	56445ASS18	56453ASS18	56459ASS18	56388ASS18	56392ASS18
H	P6H1419	P6H1419	P6H1419	P6H1419	P6H1419	P6H1419	P6H1419	P6H1419
I	P6H1418	P6H1418	P6H1418	P6H1418	P6H1418	P6H1418	P6H1418	P6H1418
J	P6H1158	P6H1158	P6H1158	P6H1158	P6H1158	P6H1158	P6H1158	P6H1158
K	/	P6(H1)510	/	/	P6(H1)510	P6(H1)510	P6(H1)510	P6(H1)510
L	/	P6H1317	/	/	P6H1317	P6H1317	P6H1317	P6H1317

CHOOSE THE CORRECT LOCATION

NOTE: The pool must be set up on a completely flat and level surface. Please do not install the pool if the surface is inclined or sloped.

Correct conditions to set up the pool:

- The selected location has to be capable of uniformly supporting the weight for the entire time the pool is installed, moreover the location must be flat and must be cleared of all objects and debris including stones and twigs.
- We recommend positioning the pool away from any objects children could use to climb into the pool.

NOTE: Position the pool near an adequate drainage system to deal with overflow or to discharge the pool.

Incorrect conditions to set up the pool:

- On uneven ground the pool may collapse causing serious personal injury and/or damage to personal property and will void the warranty and prevent any service claims.
- Sand should not be used to create a level base; the ground must be dug out if necessary.
- Directly under overhead power lines or trees. Be sure the location does not contain underground utility pipes, lines or cables of any kind.
- Do not set up the pool on driveways, decks, platforms, gravel or asphalt surfaces. The selected location should be firm enough to withstand the pressure of the water; Mud, sand, soft / loose soil or tar are not suitable.
- Grass or other vegetation under the pool will die and may cause odors and slime to develop, therefore we recommend removing all grass from the selected pool location.
- Avoid areas prone to aggressive plant and weed species that may grow through the ground cloth or liner.

NOTE: Check with your local city council for by-laws relating to fencing, barriers, lighting and safety requirements and ensure you comply with all laws.

NOTE: If have a filter pump, refer to the pump's manual for instructions.

NOTE: The ladder must match the pool size and should be used only for entering and exiting the pool. It is forbidden to exceed the permitted payload of the ladder. Check regularly if the ladder is properly assembled.

Installation

Bestway Inflatables will not be responsible for damage caused to the pool due to mishandling or failure to follow these instructions.

1. Lay out all parts and check that you have the correct quantities as listed in the components list. If you are missing any part do not assemble the pool, contact Bestway Customers Service.
2. Spread out the pool and make sure the pool is right side up, let it sit exposed to direct sunlight for 1 hour or more so that the pool is more flexible during set up.
3. Place the pool near an adequate drainage system to deal with overflow water and ensure the pool's inlet A and outlet B are correctly positioned to allow your filter pump to connect to a power source.

Note: Do not use extension power cords to power your pump. **ATTENTION:** Do not drag the pool on the ground, this can damage the pool.

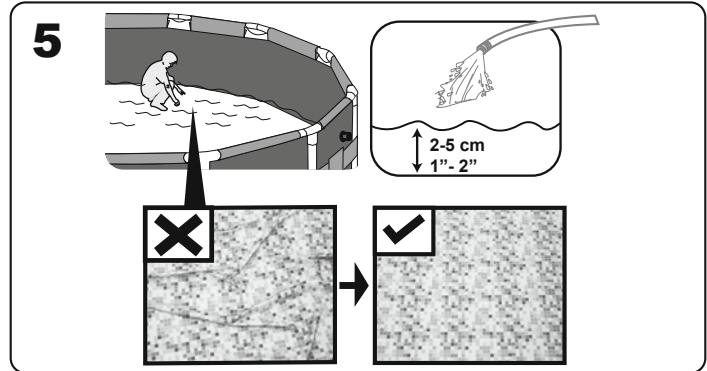
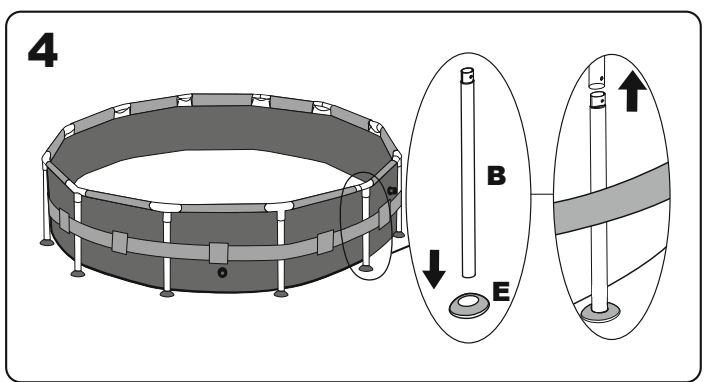
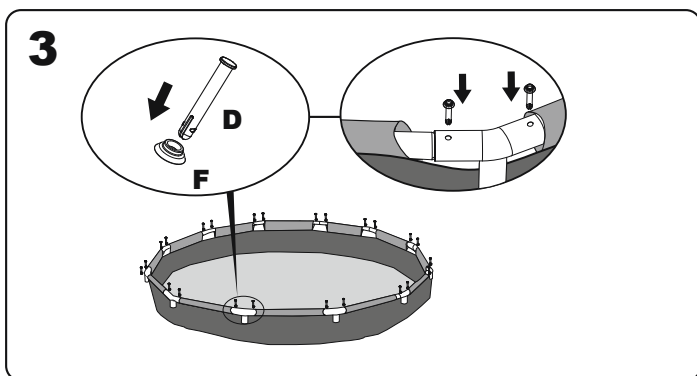
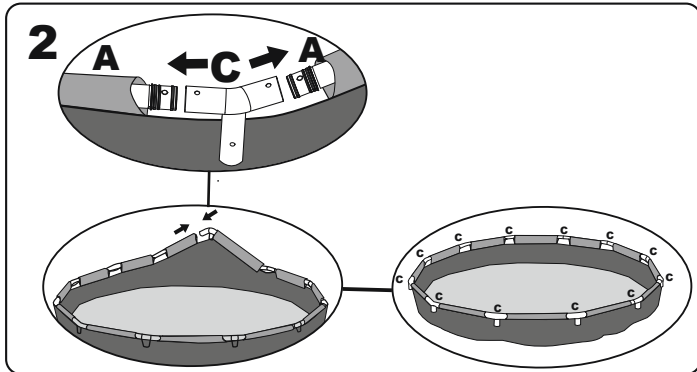
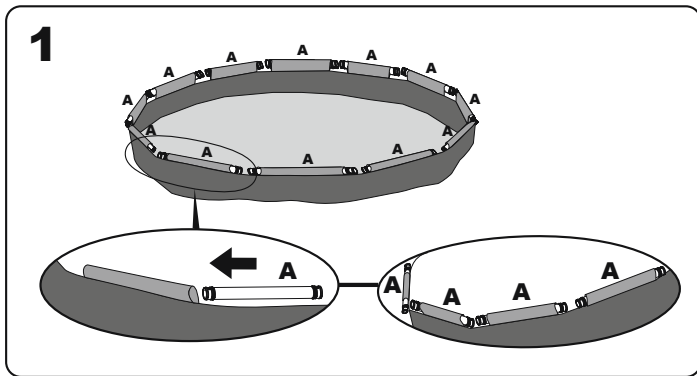

Connection Valve Assembly
For pool with connection valve.

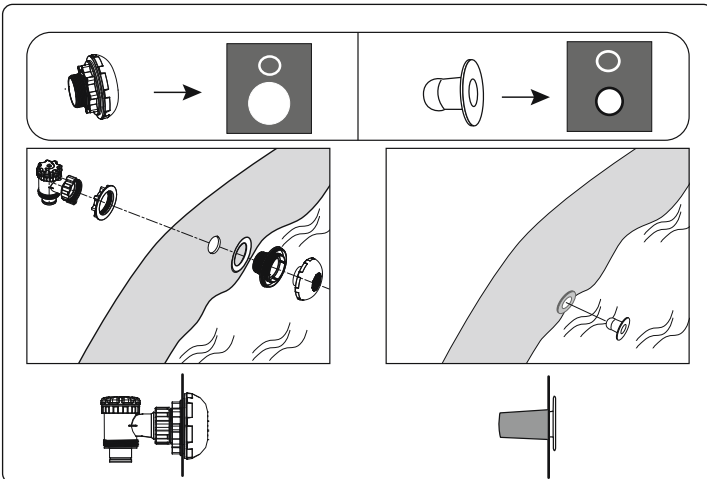

Filling Pool with Water

ATTENTION: Do not leave pool unattended while filling with water.

1. Fill pool until water capacity is 90%, DO NOT OVERFILL as this could cause the pool to collapse.

In times of heavy rainfall you may need to empty some of the water to ensure the level is correct.

2. When filling the pool is completed, check that the water is not collecting on any side to ensure the pool is level.

IMPORTANT: If pool is not level, drain water and re-level ground by digging out. Never attempt to move the pool with water in it, serious personal injury or damage to the pool may result.

WARNING: Your pool may contain a great deal of pressure. If your pool has any bulge or uneven side then the pool is not level, the sides may burst and the water may discharge suddenly causing serious personal injury and/or damage to property.

3. Check pool for any leaks at valves or seams, check ground cloth for any evident water loss. Do not add chemicals until this has been done.

NOTE: In the event of a leak, patch your pool using the underwater adhesive repair patch provided. Refer to the FAQ's for further information.

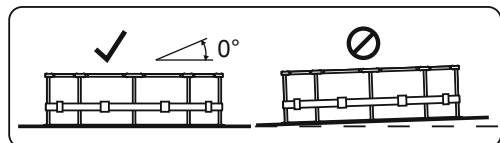
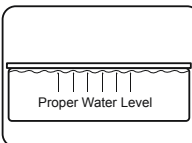
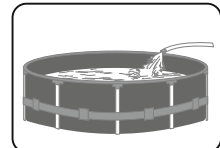

NOTE: Drawings for illustration purpose only. May not reflect actual product. Not to scale.

Pool Maintenance

If you do not adhere to the maintenance guidelines below, your health might be at risk, especially that of your children.

IMPORTANT: If you don't respect the ideal values of the water chemicals the PVC can be damaged and become discolored.

The following table lists the sequence of the tests that should be carried out for the ideal values and possible actions. Regularly check the pH value and chlorine concentration weekly and adjust to the ideal values.

TEST	IDEAL VALUES
pH value	7.4– 7.6
Cyanuric acid	30 – 50 ppm
Free chlorine	2 – 4 ppm
Chlorine compound	0
Algae	None visible
Calcium hardness	200 – 400 ppm

To keep your pool clean:

1. Contact your local pool supply shop for advice and purchase of chemicals and pH kits. One of the most important factors to increase the life of the liner is to keep continuously clean and healthy water. Please strictly follow the instructions from professional technicians for the water treatment through the use of chemicals.
2. Locate a bucket of water next to pool to clean users' feet before entering pool.
3. Cover the pool when not in use.
4. Skim pool regularly to avoid settled dirt.
5. Check and wash the filter cartridge regularly.
6. Gently clean any scum from below the top ring with a clean cloth.
7. Please be careful in case of rain water, kindly check that the water level is not higher than the expected. If so, YOU HAVE TO DISCHARGE THE EXCESS WATER.

Proper maintenance can maximize the life of your pool.

During the season of use of the swimming pool, the filtration system must be necessarily put into service every day, enough time to assure at least a complete renewal of the volume of water.

ATTENTION: Do not use pump when pool is in use.

During the season of use of the swimming pool, the filtration system must be necessarily put into service every day, enough for a long time to assure at least a complete renewal of the volume of water.

Repair

Check pool for any leaks from valves or seams, check the ground cloth for any evident water loss. Do not add chemicals until this has been done.

NOTE: In the event of a leak, patch your pool using the underwater adhesive repair patch provided. Refer to the FAQs for further information.

Dismantling

1. Unscrew the drain valve cap on the outside of the pool counter clockwise and remove.
2. Connect the adaptor to the hose and put the other end of the hose in the area where you are going to drain your pool. (Check local regulations for drainage by-laws).
3. Screw control ring of the hose adaptor clockwise onto the drain valve. The drain valve will be open and water will start to drain automatically.

ATTENTION: Water flow can be controlled with the control ring.

4. When draining is finished, unscrew the control ring to close the valve.

5. Disconnect the hose.

6. Screw the cap back onto the drain valve.

7. Air dry pool.

ATTENTION: Do not leave the drained pool outside.

Storage and Winterization

1. Please remove all the accessories and spare parts of the pool and store them clean and dry.
2. Once pool is completely dry, sprinkle with talcum powder to prevent pool from sticking together, fold pool carefully. If pool is not completely dry, mold may result and will damage the pool liner.
3. Store liner and accessories in a dry place with a moderate temperature between 5°C / 41°F and 38°C / 100°F.
4. During the rainy season, pool and accessories should be stored as per above instructions also.
5. Improper draining of the pool might cause serious personal injury and/or damage to personal property.
6. We strongly recommend the pool is disassembled during the off season (winter months). Store in a dry location out of children's reach.

Limited BESTWAY® Manufacturer's Warranty

The product you have purchased comes with a limited warranty. Bestway® stands behind our quality guarantee and assures, through a replacement warranty, your product will be free from manufacturer's defects.

To enact a warranty claim, this form must be completed and submitted with a copy of your receipt/purchase to your local Bestway After Sales Center. Before any claims can be accepted, the Bestway After Sales Center may ask you to send a piece of the defective part to the center (e.g. a cut out of the production batch number / drain valve). Please contact your local Bestway After Sales Center before sending any documents. They will provide full instructions of what is needed for your claim.

Bestway® is not responsible for economic loss due to water or chemical costs. Bestway® will not replace any products deemed to have been damaged due to negligence or used outside of the owner's manual guidelines.

Bestway's warranty covers manufacturing defects discovered while unpacking the product or during use, within the limits of a use and respectful of warnings and instructions given within the user's manual. This warranty applies only to the product and must not have been modified by any 3rd parties. The product must be stored and handled in accordance with the technical recommendations.

Our goods come with guarantees that cannot be excluded under the Australian Consumer Law. You are entitled to a replacement or refund for a major failure and compensation for any other reasonably foreseeable loss or damage. You are also entitled to have the goods repaired or replaced if the goods fail to be of acceptable quality and the failure does not amount to a major failure.

Please choose the type of your pool:

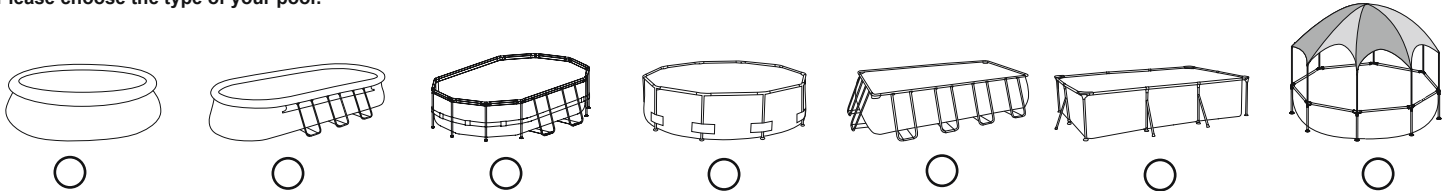

Date of purchase: _____ Customer Code Number: _____

TO: Bestway® Service Department Date: _____

FAX/E-MAIL/TEL: Please refer to your country according to the information you find on the back cover or on our website: www.bestwaycorp.com. Please provide your address details in full. **Note:** Incomplete address details will result in delayed shipments. Bestway reserves the right to charge for redelivery of undelivered packages where the recipient is at fault.

REQUIRED INFORMATION - PLEASE WRITE THE SHIPPING ADDRESS

Name: _____ Address: _____
 Zip Code: _____ Retailer: _____
 Country: _____ City: _____
 Mobile: _____ Telephone: _____
 Fax: _____ E-mail: _____

Please write the Batch Number and Item Code located near the drain valve

Batch Number: _____ Item Code: _____

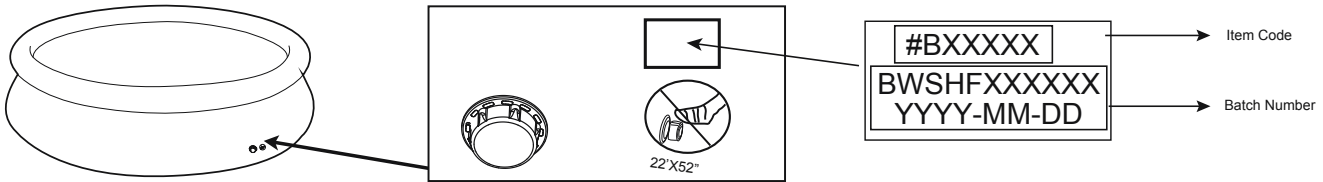

Problem description

- Item is torn / Leaking
- Faulty welding
- Faulty upper ring
- Faulty drain valve
- Other (Please describe)
- Missing part (Please use the code for the missing part. This can be found in the owner's manual.)

IMPORTANT: ONLY THE DAMAGED PART WILL BE REPLACED, NOT THE COMPLETE SET.

Bestway reserves the right to request photographic evidence of defective parts, or to require sending the item for additional testing. In order to better assist you, we request all information you provide to be complete.

FOR FAQ, MANUALS, VIDEOS OR SPARE PARTS, PLEASE VISIT OUR WEBSITE: www.bestwaycorp.com
 VIDEOS ARE ALSO AVAILABLE ON OUR BESTWAY CHANNEL ON YOU TUBE: www.youtube.com/user/BestwayService

